

 **Valico**

GESTIONE DEL VAPORE



SCARICATORI DI CONDENSA E VALVOLE



RIDUTTORE DI PRESSIONE MANUALE PRV25

DESCRIPTION

The ADCA PRV25 is a series of direct acting pressure reducing valves designed for use on steam, compressed air, water and other gases and liquids. These regulators are suitable for reducing steam pressure at the point of use on laundry machines, dyeing, food industries, sterilizers, etc.

MAIN FEATURES

Compact design.
Bellows specially designed for high durability.
Non-rising adjustment knob.
Lockable knob system.
Built-in strainer.

OPTIONS: Rising adjustment knob with lock nut.
Top cap (adjustment screw with cover).
Spring and dome load version.
Gauge connection on body.

USE: Saturated steam, compressed air, water and other gases and liquids compatible with the construction.

AVAILABLE MODELS: PRV25/2S and PRV25/2SG – carbon steel.
PRW25/2S – carbon steel, balanced soft sealing.
PRV25i and PRV25iG – stainless steel.
PRW25i – stainless steel, balanced soft sealing.
Suffix G: soft sealed with PTFE/GR.

SIZES: 1/2" to 1"; DN 15 to DN 25.

CONNECTIONS: Female threaded ISO 7 Rp or NPT.
Flanged EN 1092-1 PN 25.
Flanged ASME B16.5 Class 150 or 300.

INSTALLATION: Horizontal installation is recommended.
A "Y" strainer should be installed upstream of the valve.
See IMI – Installation and maintenance instructions.



CE MARKING – GROUP 2 (PED – European Directive)

PN 25	Category
DN 15 to 25	SEP

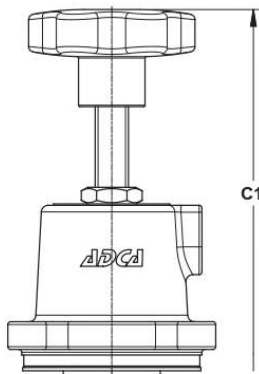
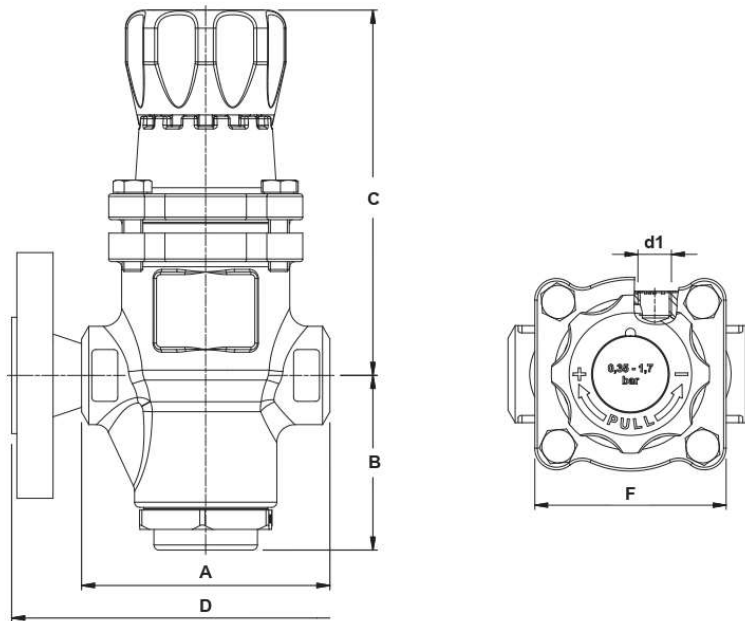

Optional rising adjustment knob

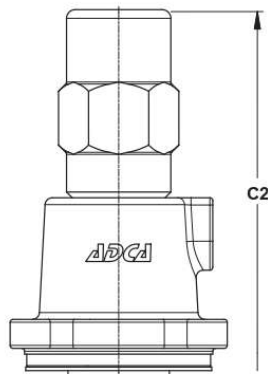

Optional top cap

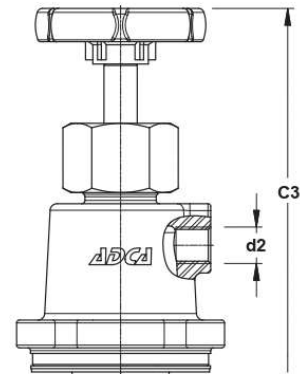

Optional spring and dome loaded version

DIMENSIONS (mm)																
SIZE	THREADED									PN 25		CLASS 150		CLASS 300		
	A	B	C	C1	C2	C3	d1 *	d2 **	F	WGT. (kg)	D	WGT. (kg)	D	WGT. (kg)	D	WGT. (kg)
1/2" – DN 15	96	68,5	141	242	237	243	1/4"	1/4"	74	3	150	4,4	150	4	150	4,4
3/4" – DN 20	96	68,5	141	242	237	243	1/4"	1/4"	74	3	150	5	150	4,4	150	5,3
1" – DN 25	96	68,5	141	242	237	243	1/4"	1/4"	74	2,9	160	5,5	160	5,1	160	5,9

* Optional gauge connection; ** Loading gas dome connection.

Remarks: As standard, in versions manufactured with EN 1092-1 PN 16 flanges or ISO Rp threads, connections d1 and d2 are female threaded ISO 7 Rp. In versions with ASME B16.5 flanges or NPT threads, these connections are female threaded NPT.